

SOFTOPPER[®]

Ridgeline 60 Installation Instructions

Please read instructions thoroughly before starting installation

****Remove all contents of the Softopper carefully to protect from scratches.**
Windows scratch easily! Keep protective layer placed between them when they are stacked.**



Estimated Installation Time: 1 hour

Beginning Note: It is easiest to do the initial installation in warmer temperatures. The fabric of the top is at its tightest when it is new. Installing it in warmer temperatures initially will ensure that the fabric is easier to work with. The fabric of the top will relax slightly with time and become easier to put on.

****Safety Notes****

Please read the following before driving with the Softopper installed:

1. It is highly recommended that a boot cover/storage bag (sold separately) is used when the topper is in its retracted position. This will prevent the top from catching in the wind and extend the longevity of the soft top.
2. DO NOT rely in any way on the soft top to contain occupants or objects within the vehicle bed, or to protect against injury or death in the event of an accident or a roll-over.
3. This top will not protect the occupants or objects from falling or flying objects. Never operate vehicle in excess of manufacturer's recommendations or specifications.

Tools needed for installation:

- #3 Phillips Screwdriver
- Torx T-30 Tool (provided)

Table of Contents

1. Inventory.....	3
2. Hardware Installation	
1. Bedrails.....	4
2. Folding Frame.....	10
3. Soft Top Canopy Installation.....	12
4. Retracting the Soft Top.....	17
5. Optional Driving Configurations.....	19
6. Rear Screen Installation (*Purchased Separately).....	21
7. Softopper Care and Maintenance.....	22
8. Warranty Information.....	23

Your Softopper Kit Includes the Following Pieces



1. Driver Side Bedrail

2. Passenger Side Bedrail

3. Front Bedrail **Note: This bar is bent on purpose and is not damaged.

4. Rear Bar

5. Cross Bars (4)

6. Driver Side Upright

7. Passenger Side Upright

8. Softopper Canopy (not depicted above)

9. Various brackets and Hardware (not depicted above)

10. Pack of Velcro (not depicted above)

Bedrail Installation

****Note** Driver side depicted in all photos and illustrations throughout instructions. Also, colored instructions are available on our website, softopper.com, under "Installation Instructions".**

1. Locate the Driver Side bedrail, which has a sticker indicating the Driver Side bedrail.

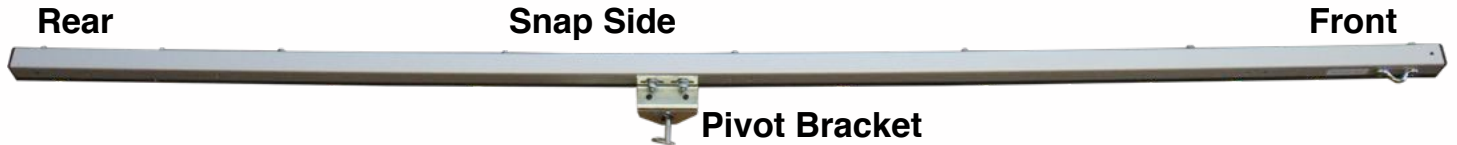

2. Remove the white paper from the under side of the weather stripping.
**The weather stripping is NON-ADHESIVE and will not stick to your truck.

3. Locate the 3 pairs of bedrail brackets (6 total) and the bag containing 22 #12 screws and 2 washers.

**Note: We have also provided a small bag with a few extra screws of size #14 just in case any of the pre-drilled holes in the bedrails become stripped out.

4. Mount the 6 brackets to the bedrails using a #3 Phillips screwdriver with 2 of the #12 screws per bracket through the

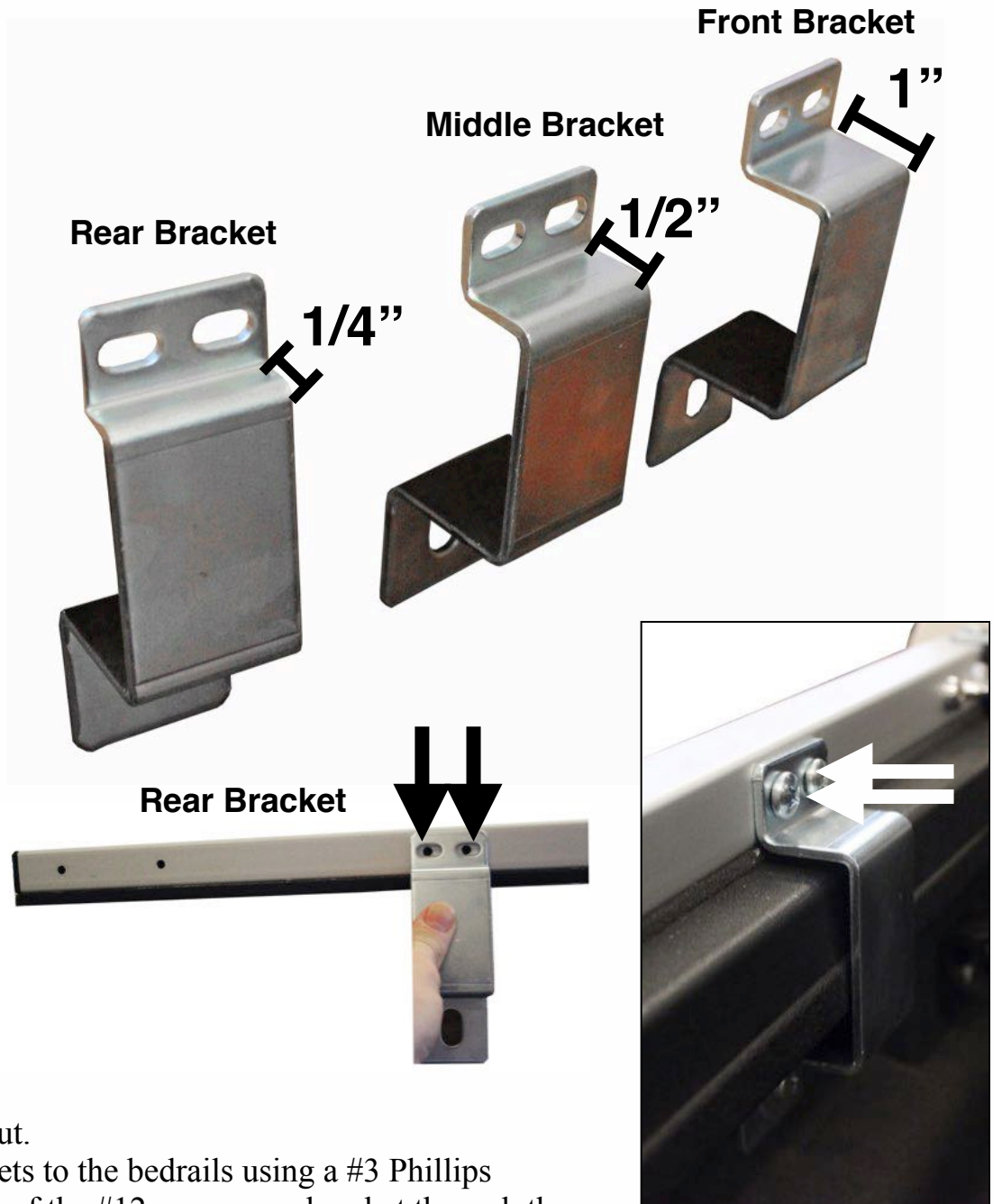

pre-drilled holes in the bedrails and the 2 slots in the top of each bracket. Center the screws in the slots and secure. Make sure the widest bracket is at the front, the middle bracket in the middle, and the smallest bracket at the rear of the truck bed. The remaining #12 screws will be installed elsewhere later.

5. Using a Torx T-30, remove the 6 bolts in the truck bed near the front, center, and rear, as shown below. The depicted brackets will be installed later.

Torx T-30

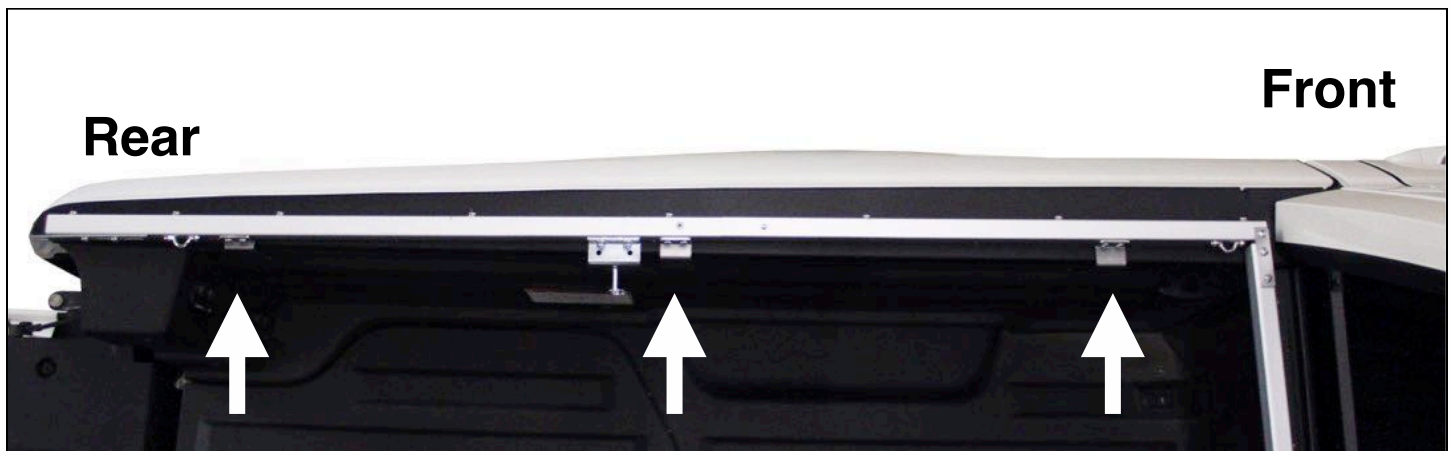
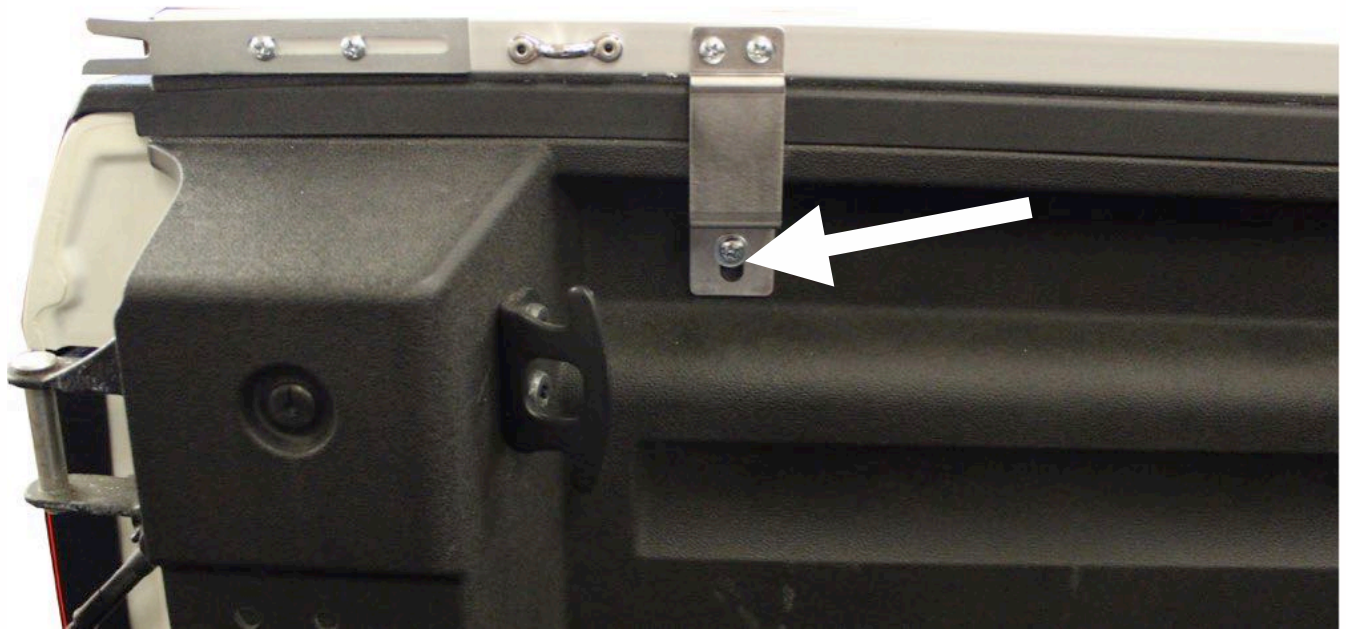

6. Place the Driver Side bedrail atop the side of the driver side of the truck bed rail with the snaps facing outward as shown.

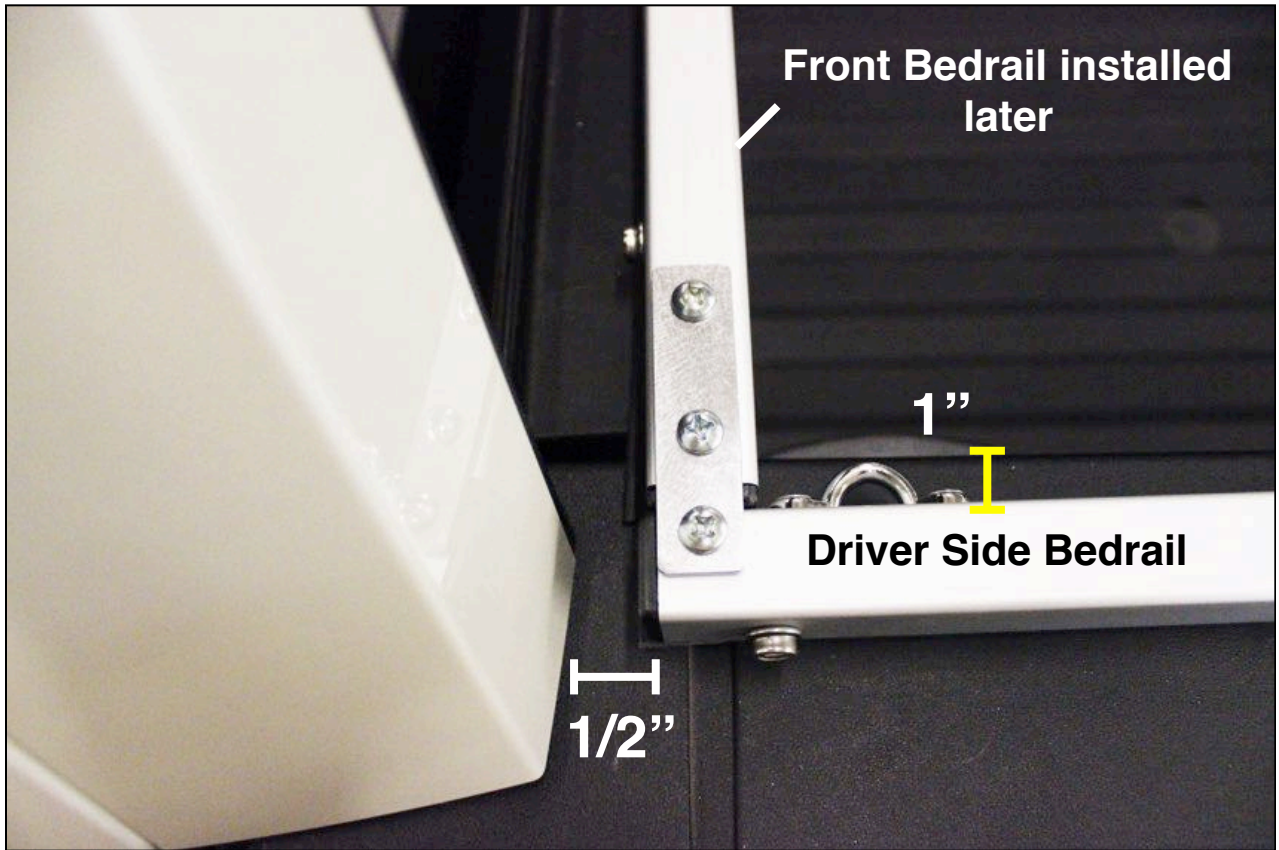

7. If the bedrail brackets were installed correctly, the proper alignment of the bedrails will be as follows: The FRONT of the bedrail will be about 1/2" from the truck cab and 1" from the inside of the truck bed. The inside edge of the REAR of the bedrail will be flush with the inside edge of the truck rail.

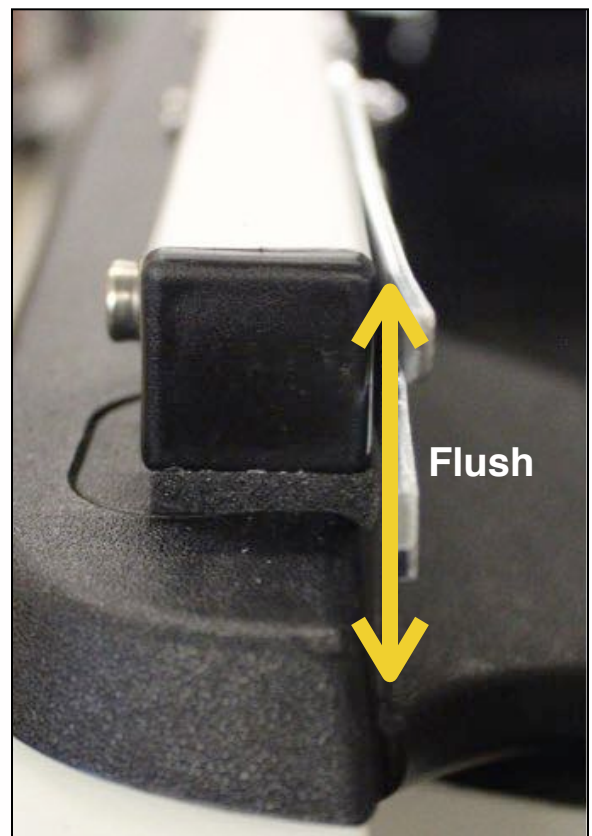

8. Locate another small bag containing (6) M6 screws, 6 washers, and the provided Torx T-30 tool. LOOSELY mount the 6 bedrail brackets to the truck bed using a #3 Phillips screwdriver. Place one washer and one M6 screw through the bottom slot of each bracket. Readjust the previously installed #12 screws if further adjustments are needed for proper alignment.

9. Locate the 2 small 2" strips of weather stripping. Take the white protective paper off of the adhesive side. With the ADHESIVE SIDE UP, place the weather striping under the front of the bedrail where there is a groove in the truck bed's rail. Press down firmly on the bedrail once the weather striping is in place.
10. Tighten all M6 screws to fully secure the bedrails and ensure a waterproof seal underneath the bedrails.

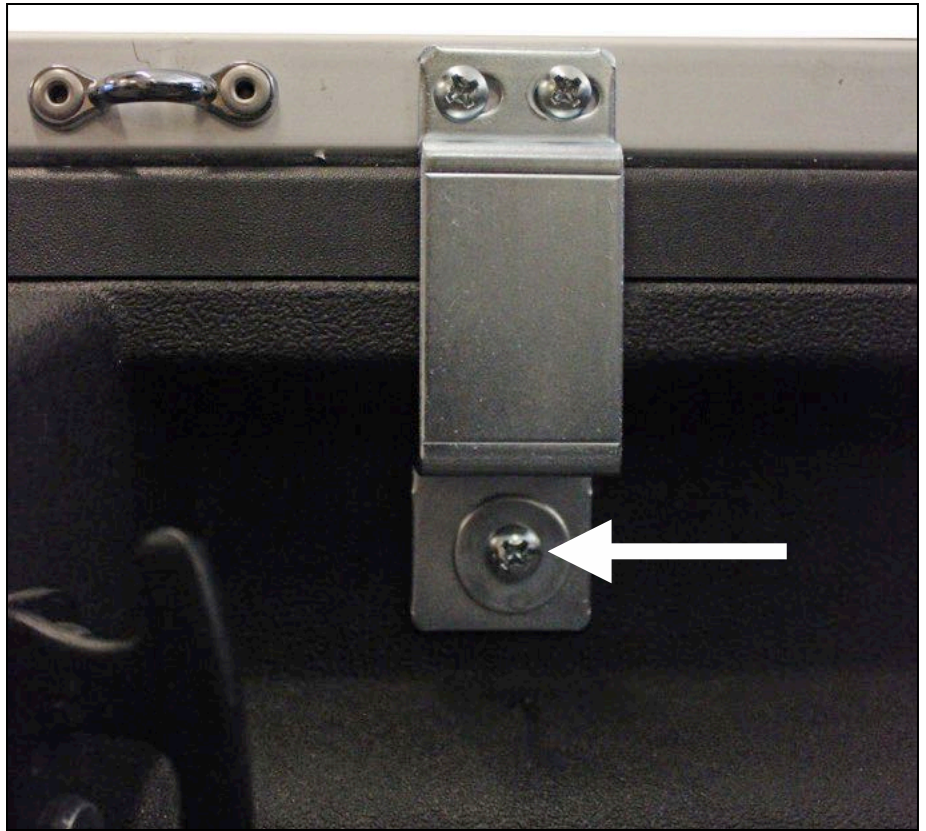

11. Locate the 2 Rear Bar Brackets and the 2 webbing straps with snaps. Using 1 of the #12 screws, 1 washer for each bracket, and a #3 Phillips screwdriver, mount the webbing snap flap and the bracket to the rear of the bedrail through the 2nd most rearward pre-drilled holes. Ensure that the flange with the hole in it is projecting into the truck bed and the snap is facing DOWN as shown below. Use another #12 screw to mount the bracket to the bedrail through the rear most pre-drilled hole in the bedrail. Align the bracket as shown, with the gap between the 2 prongs beginning just at the edge of the bedrail. The rear bar will later slide into this gap. Repeat this step on passenger side bedrail.

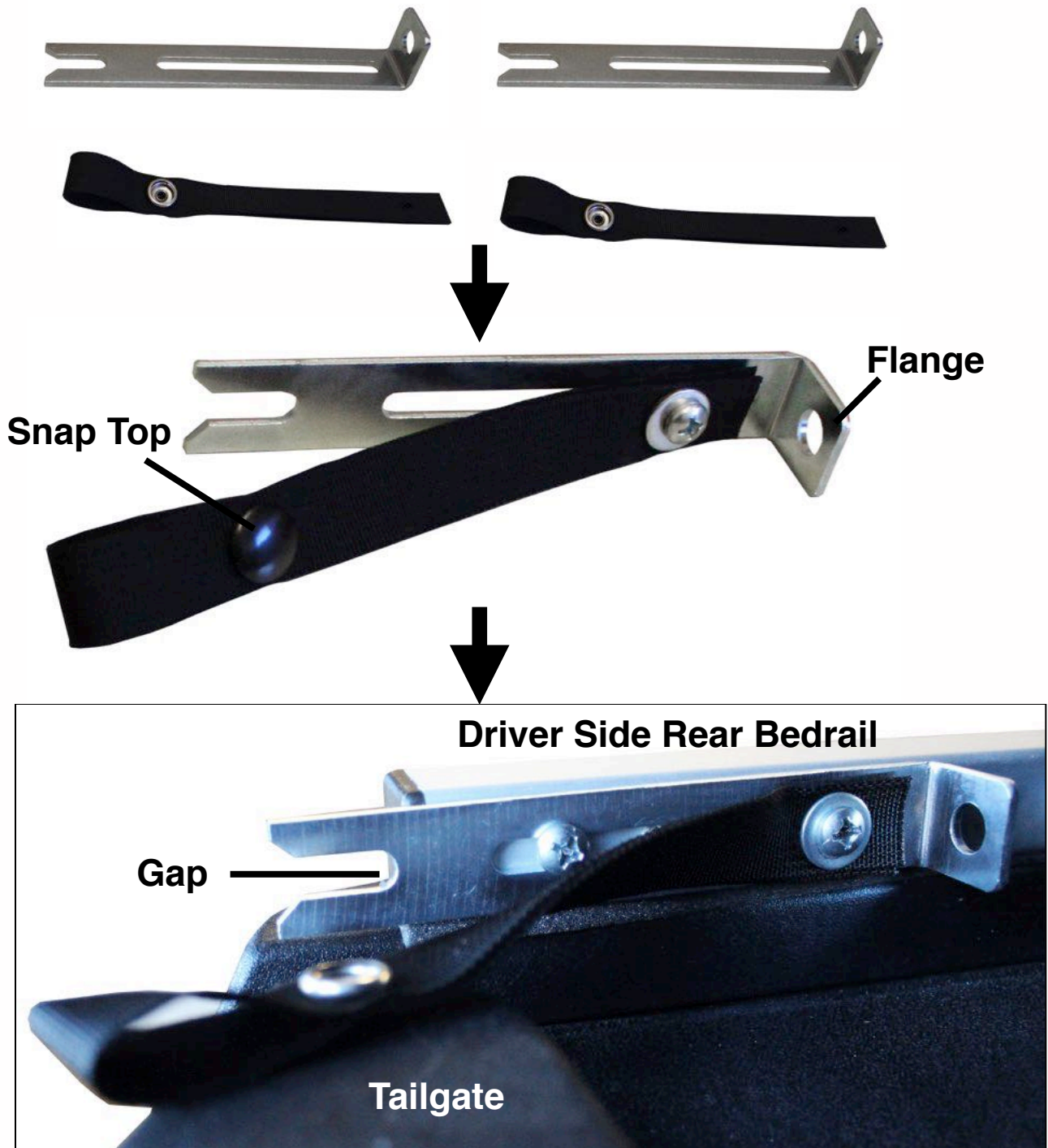

12. Locate the Front Bedrail, and the 2 small brackets in the bag with the #12 screws. Note that

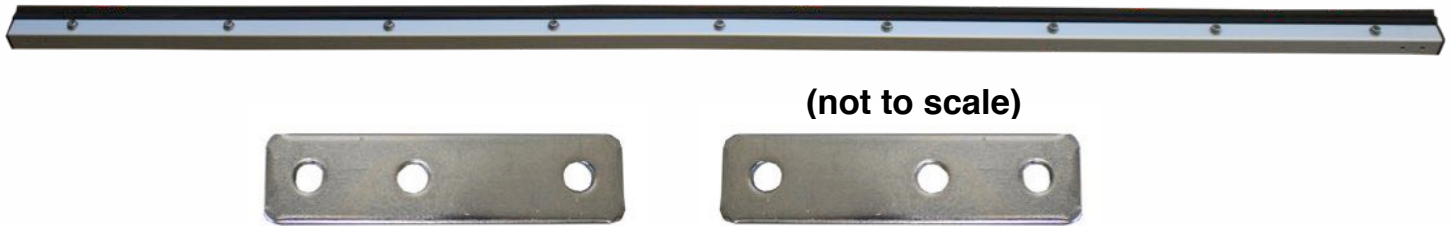

the front bedrail is slightly curved to provide adequate pressure forward and down. The bar is not damaged.

13. Place the Front Bedrail on the front of the truck bed with the bulb seal down and the snaps facing forward.

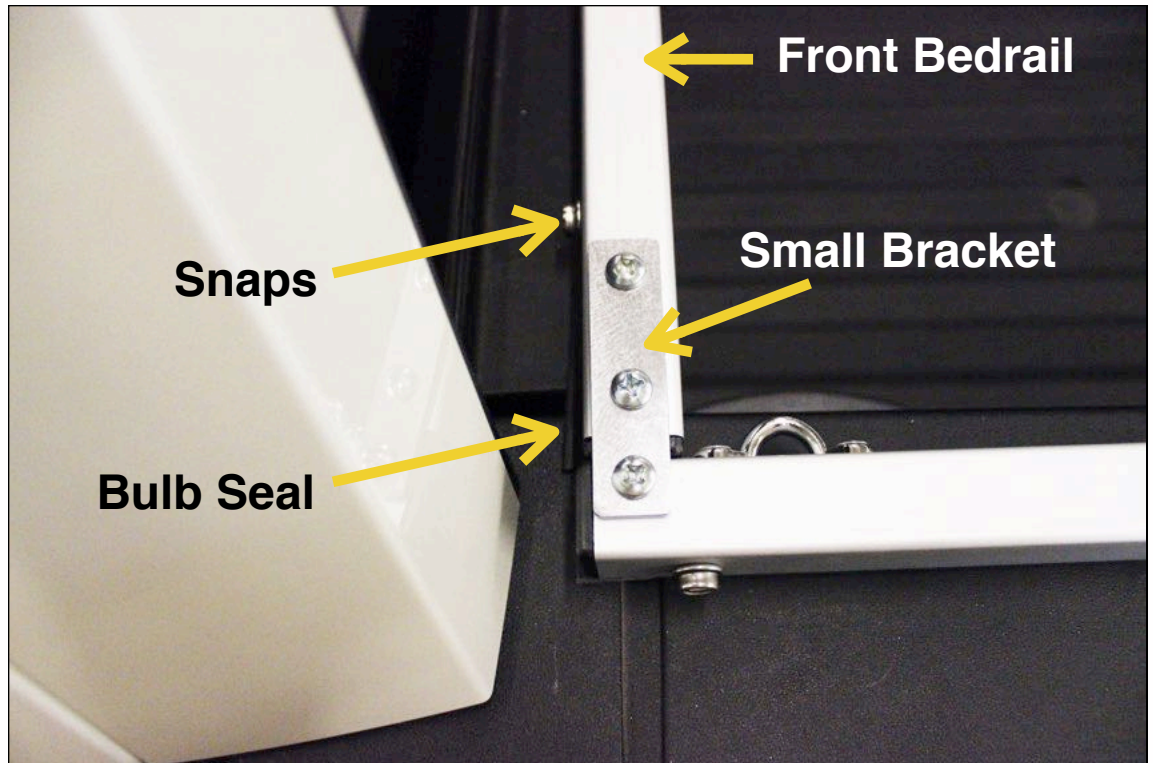

14. Mount each bracket to the Front Bedrail and then to both Driver and Passenger side bedrails using 3 #12 screws each.

Folding Frame Assembly and Installation

1. Locate the 4 Cross Bars and the 2 Folding Frames.

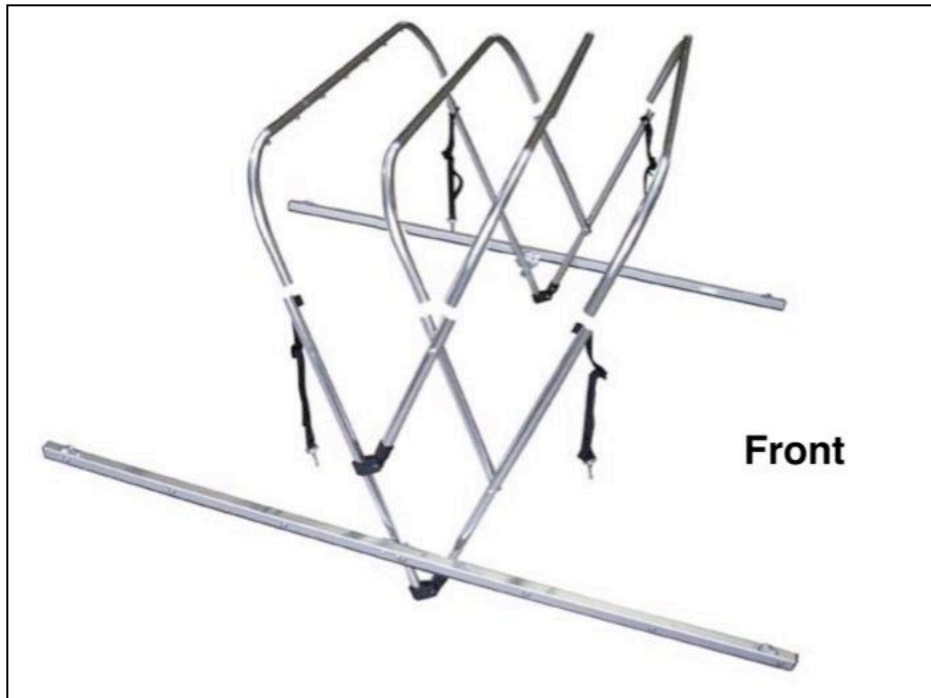

2. Join the 4 cross bars to the 2 folding frames by coordinating the **COLORED DOTS** provided on the pieces and ensuring ALL push pins are locked into their holes.

****Important: Keep fingers clear of the sharp, metal junction where the cross bars will meet the folding frame when clipping them together. Injury is likely if fingers get pinched.**



3. ****Tip: It helps to stand the folding frame uprights up, and with another person, jiggle the cross bars down to join them to the uprights.**

4. Remove the safety rings from the pivot pins in the pivot brackets by turning the ring.

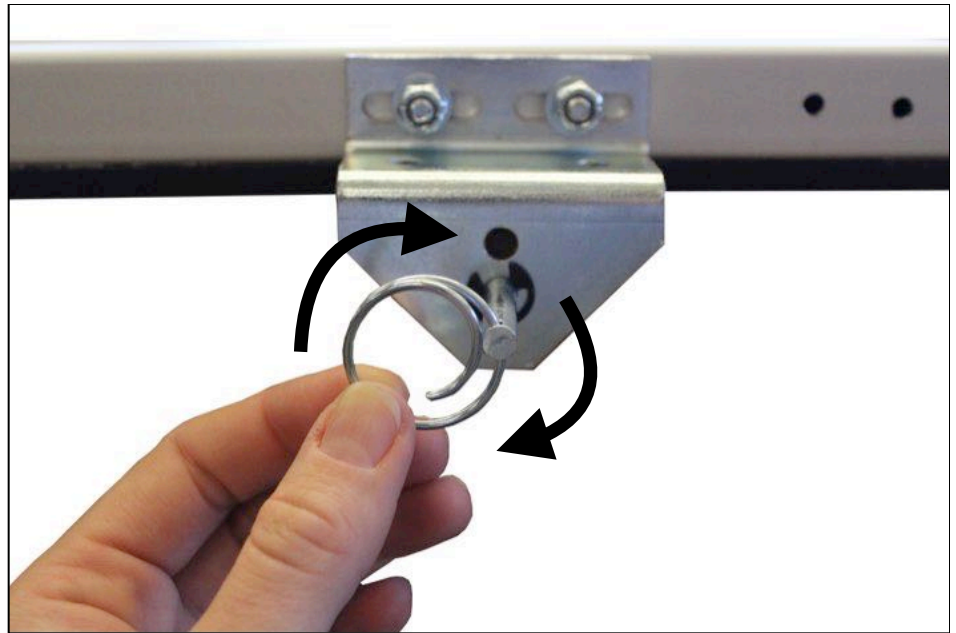

5. Using the pre-drilled holes near the bottom of the folding frame, slide the frame onto the pivot pins on each bedrail ensuring the **forward cross bar is forward**. The forward crossbar is the one with the **RED DOT**. Secure the safety rings back on. [The most common installation error is installing the frame on backwards. View photo to ensure correct orientation of the folding frame.]

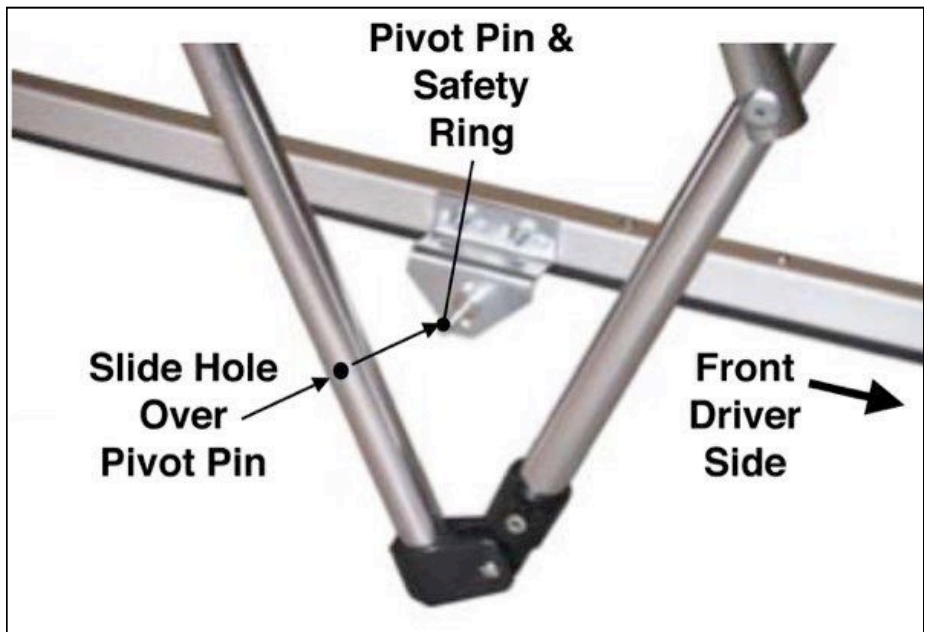

6. **Note:** when reopening the frame from its front position, you must raise all of the cross bars to approximately cab-height before opening the folding frame completely. If the rear cross bar is raised on its own, it will force the forward most cross bar into the cab window.
7. Leave the 4 safety straps that are hanging on the folding frame unclipped for now.

Soft Top Canopy Installation

1. With the tailgate open, lower the folding frame to the rear of the vehicle.
2. Carefully place the canopy on the tailgate, as shown.



3. Locate the rear window panel snap flap and place it facing up and forward. The rear window has zippers, but the front one does not.
4. Snap the canopy to the snaps on the bottom/rear most cross bar by slipping the fabric **UNDER** the bar and around as shown. Snap the 2 outward most snaps first, then the remaining snaps.

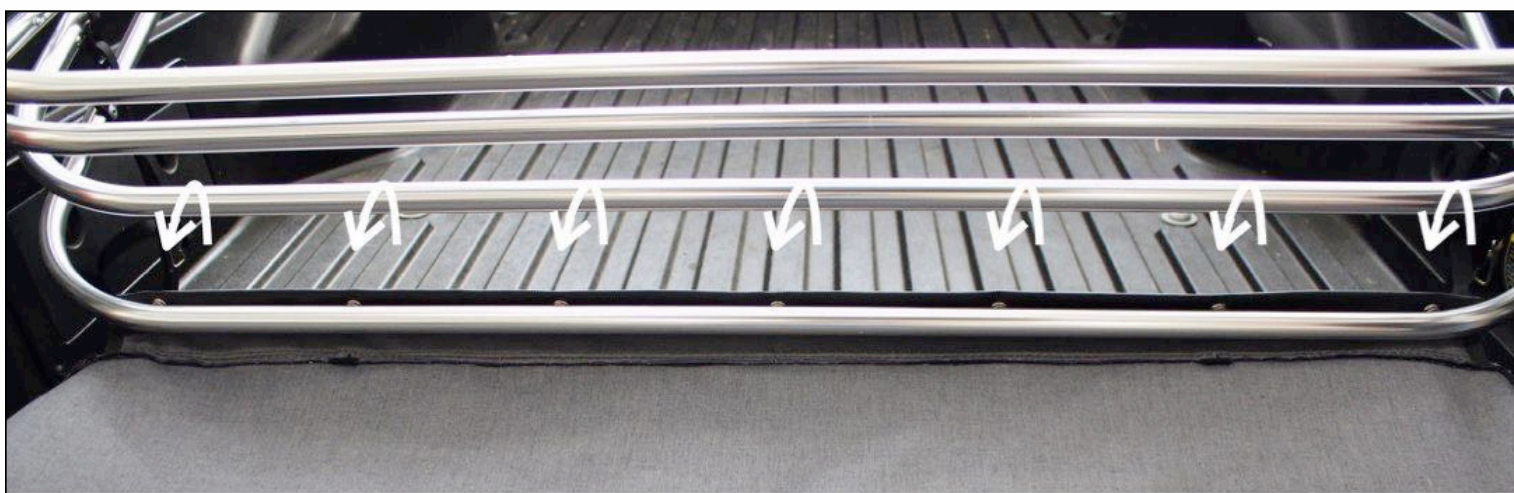

5. Locate the front snap flap.

6. With the snaps facing down, wrap it **OVER** the upper/forward most cross bar (the other one with snaps), and snap all the snaps in the same manner as the rear.

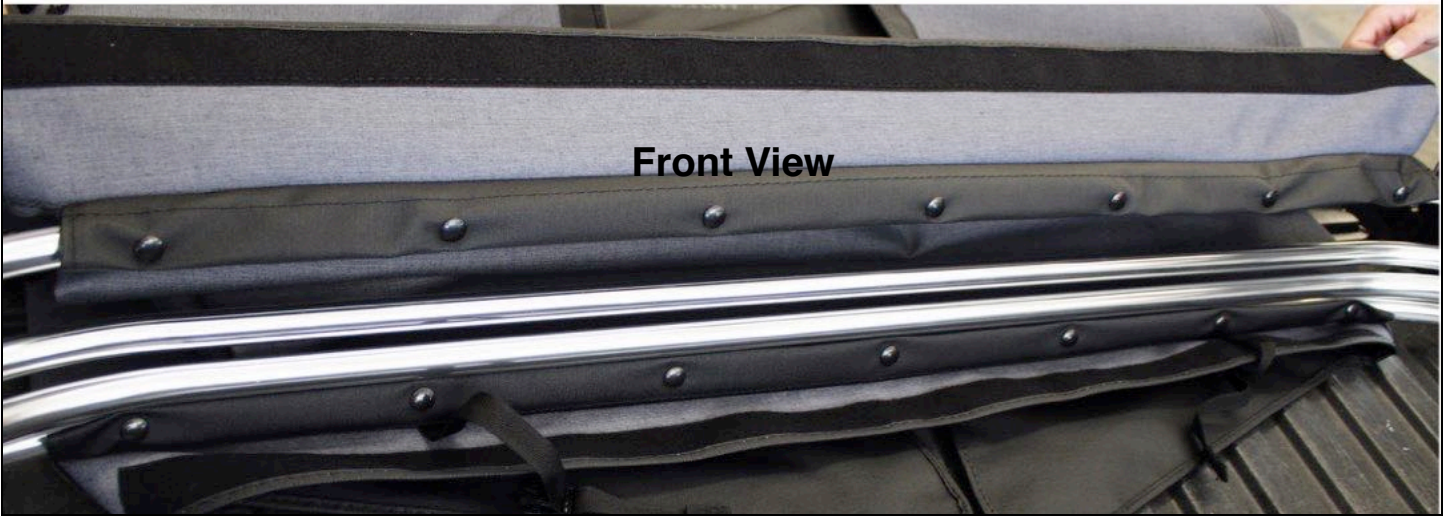

7. From the side of the vehicle, raise the folding frame up into its upward position.

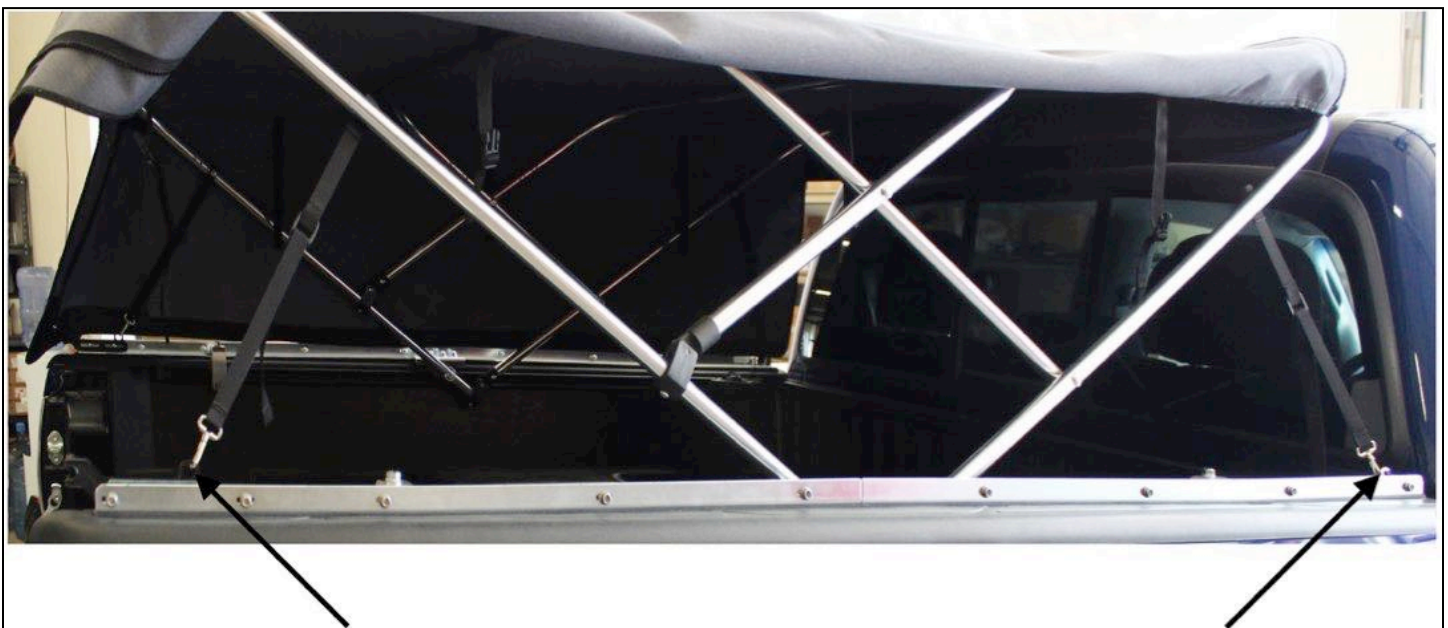

8. Loosely latch the 2 rear safety straps to the hole in the flange on the rear bar brackets and the 2 front safety straps to the bedrail loops as shown below. The straps are already riveted to the folding frame.

Front Safety Strap



Rear Safety Strap

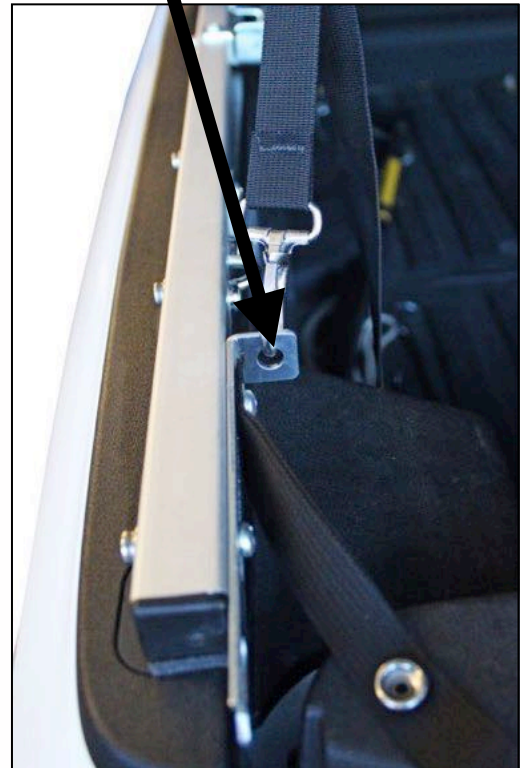

9. Tighten down on each of the safety straps by pulling down on the front and rear cross bars strongly.
10. Undrape the front window and snap it to the Front Bedrail.
11. Undrape the side panels. Snap the front most snap only.
12. On the same side, while pulling down on the rear cross bar, tighten the rear safety strap. The safety straps should be snug, not loose nor overtightened.
13. Connect the rear most snap on the side panel to the rear most snap on the bedrail. This may take a little extra force the first time, and the top will loosen slightly after the first installation.
14. Tighten the safety straps further to relieve excess tension on the snaps. ****Note that it is a good idea to share tension between the safety straps and the snaps instead of having all the tension only on the snaps.** This will also help with any wrinkles in the corners.
15. Now snap the rest of the snaps on the driver side.
16. Repeat the above on passenger side. Note that we recommend snapping the front most and rear most snaps



first each time you close the top. This makes it easier to snap the remaining snaps and align the canopy properly.

17. At this point or any other point during the life of your Softopper, if the canopy is too loose or too tight, you can move the pivot pin to a higher or lower hole in the pivot bracket. Be sure to reinstall the black, plastic E-Clips onto the pivot pins. Also, ensure with any new adjustments that the folding frame does not impact the cab window.
18. Make sure the E-Clip is in the small indent in the pivot pin. It helps to use the flat edge of something metal to push the E-Clip on.

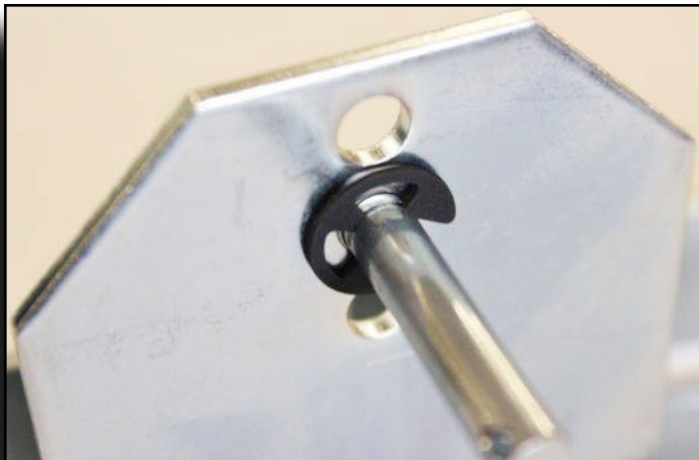

19. Locate the Rear Bar and lower the Rear Window.



20. With the snap on the end facing UP, slide the bar into the 3 sleeves at the inside base of the rear window.

21. Push the two plastic ends into the gaps in the rear bar retainers.



22. SNAP the rear bar into place with the webbing snap flap that is attached to the rear bar retainer.

23. Zip closed the rear window panel.

24. Close the tailgate while lifting up slightly on the fabric hanging at the bottom of the window panel.

25. Secure velcro around the front and rear window panels.

26. ****Optional:** Use the provided extra strips of velcro to hold the bottom of the rear window flap to the tailgate. Wipe clean and dry the tailgate surface before placing the sticky side of the velcro onto the vehicle. Before putting tension on the velcro, we recommend letting it adhere for **24 hours**.

Installation Complete!

****See the following pages for retraction instructions and optional driving configurations.**

Retracting the Softopper

1. Undo all side snaps.
2. Raise the rear window panel zippers all the way to the top without disconnecting them.
3. Release the rear window retainer bar.
4. Optional: Unsnap the front window.
Carefully and neatly fold the front window on top of the canopy without creasing the window. You can leave the front window secured while retracting the canopy.



5. Fold the side panels up onto the roof canopy neatly.
6. Fold the rear window panel up onto the roof as well with the upper zippers still connected. You can keep the bar in the rear window or remove it.
7. Release the 2 rear safety straps.



8. Standing on the tailgate, or from the side of the vehicle, fold the folding frame forward with the entire canopy on top of the cross bars. The top should fold itself nicely into sections without damaging the windows. Ensure the correct folds are made the first few times.

9. ****Clip the 2 rear safety straps onto the bedrail loops and tighten them for safety while driving.**

10. Optional: Place your Softopper boot cover (purchased separately) around the Softopper to make for clean, easy storage on or off the vehicle.

11. To fully remove the Softopper, release all 4 safety straps, remove the 2 safety rings from the pivot pins, and completely remove the folding frame. Reinstall the safety rings. Optional boot cover can be placed around the Softopper to make for clean, easy storage on or off the vehicle.

12. ****Optional:** Roll the side panels and the rear window up to create an open air truck bed without removing the upper canopy as shown. Carefully and neatly roll up the panels and secure them by buckling the straps on the canopy. The truck can be driven with the rear window rolled up, and the sides rolled up. However **DO NOT** drive the vehicle with the side panels rolled up and the rear window down due to wind resistance potentially causing damage to the rear window or release of the rear bar from the bar retainers.



Optional Driving Configurations

1. Retracted without boot cover.
**Secure both Safety Straps to bedrail loops!



2. Retracted with boot cover (purchased separately; makes for clean, easy storage on or off the vehicle). **Leave one safety strap on each side out of the boot cover and secure them to bedrail loops!



3. Rear window rolled up and buckled.
4. Rear window removed.
5. Front panel removed.



6. Side panels and rear window rolled up and buckled. **Rear window MUST be rolled up if side panels are rolled up.



7. Side panels partially rolled up.



8. Softopper canopy and folding frame removed from vehicle. Leave bedrails installed. To fully remove the Softopper, release all 4 safety straps, remove the 2 safety rings from the pivot pins, and completely remove the folding frame. **Reinstall the safety rings.** Optional boot cover can be placed around the Softopper to make for clean, easy storage on or off the vehicle.



Rear Screen Installation

***Purchased Separately**

1. Open the tailgate. Unzip the rear window.
2. Completely remove the rear bar from the rear window.
3. Sit inside the Softopper on the tailgate, facing the rear window.
4. Undo the small, velcro flap covering the top of the zippers on each side of the rear window, and unfasten the zippers from the other half on the Softopper roof.
5. Pull the window to completely detach it from all of the velcro holding it on at the top. Gently place the window in a storage location where it will not get scratched.
6. While still sitting in the truck bed, place the screen panel right side out.
7. Attach the zippers first, and only pull them down a little bit. Secure the small velcro flap over the top of the zipper.
8. Make sure the roll-up straps are on the inside of the screen panel.
9. Find the small hole in the screen panel that is at the top, in the center. Line the hole up with the center snap on the cross bar above the velcro.
10. Secure the velcro all the way across the top of the screen panel evenly. No velcro should be showing on the outside of the window panel.
11. Slide the rear bar into the pocket at the bottom of the screen panel.



Softopper Care and Maintenance

Your top is made of the finest materials available. To keep it looking new and for product longevity and durability, it will need periodic cleaning and maintenance. All pieces are individually replaceable; call 1-800-810-7227, or order your parts online at Softopper.com.

Washing: The fabric should be washed from time to time using a mild soap and warm water. Be sure to rinse all soap off the top when washing is complete.

Vinyl Windows: Windows should be kept clean to avoid scratching. Wash with a water-soaked sponge or cloth and a mild dishwashing detergent. Do not use a coarse brush on the windows and never wipe the windows when they are dry.

COLD WEATHER: As with all automotive and marine vinyls, extreme care must be taken when rolling up or folding the windows in cold temperatures. Vinyl becomes stiff in cold temperatures and may crack. Retracting the Softopper in cold temperatures is not recommended and will void the warranty for the windows (see Warranty information for more detail on length of window warranties). When opening the rear of the Softopper in cold weather, be sure to raise the zippers as high as possible so that any folding will occur to the topper fabric and not to the vinyl window.

Zippers: Keeping the zippers clean and lubricated with a silicone lubricant will help prevent damage and keep the zippers in smooth working condition.

Leakage: As with any sewn automotive top there is always a slight risk of leakage. Right out of the box the Softopper may not be 100% waterproof. If you experience any water seeping through at the seams, apply Seam Sure (sold separately), on the **INSIDE** of the affected seams. Shake Seam Sure well and apply liberally to the inside seams concentrating on areas where needle and thread penetrated the fabric.

Snaps: Keep snaps clean and lubricated with a silicone lubricant to help prevent snaps from sticking to the studs. If a snap does become stuck to a stud, use a screwdriver and gently pry apart to prevent damage to the snap or top fabric. If any snaps need to be replaced due to sticking or damage please call Softopper and we can send out a small do-it-yourself repair kit.

For further information please contact:

Softopper LLC, customer service
(800) 810-7227 or (303) 304-0533

Warranty

We warrant all of our Softoppers to be free from defects in material and workmanship for a period of one year, with the exception of vinyl windows and zippers, provided there has been normal use and proper maintenance.

Vinyl Windows are warranted for a period of 3 months from the date of purchase.

Zippers are guaranteed to be in perfect working condition when leaving the factory. Due to atmospheric conditions, dirt, sand, road grime, dust, and abrasive cleaners, etc., zippers are warranted for a period of 6 months from the date of purchase.

Toyota 4 Runner, Jeep Wrangler, Blazer, Jimmy, Scout, Bronco, and RamCharger side curtain windows are warranted for 45 days from the date of purchase. Retracting or closing the top when the temperature is below 40 degrees may void the warranty on the side windows, as clear vinyl plastic can crack very easily at these temperatures. Use caution when retracting the top or cleaning off the windows in freezing temperatures.

Softopper Consumer Returns Policy

We want you to be thrilled with your Softopper purchase. We are committed to providing you with the highest quality products possible, worthy of your trust and confidence.

If for any reason, you have concerns, questions, or need assistance with a product, please reach out to us: Contact us before returning it. We have found that when a product is not working as expected, a few adjustments or corrections can often set things right.

You may return a Softopper product within 30 days of your purchase, provided that the product is in its original packaging, and includes all original packaging. Please take note of our Exclusions on Returns:

We cannot accept products that are damaged due to negligence, abuse, or misuse.

IMPORTANT: ALL RETURNS MUST REFERENCE AN APPROPRIATE RGA (RETURNED GOODS AUTHORIZATION) NUMBER, WHICH MAY BE OBTAINED FROM A SOFTOPPER CUSTOMER SERVICE AGENT AT #800-810-7227, VIA LIVE CHAT, OR BY EMAILING info@softopper.com. PLEASE WRITE THE RETURN AUTHORIZATION NUMBER BELOW OUR ADDRESS ON THE OUTSIDE OF THE BOX. ANY RETURNS WITHOUT A VALID RETURN AUTHORIZATION NUMBER WILL BE REFUSED.

Returns Policy

Please call us at 800-810-7227, via Live Chat, or log in to your account, for an RMA and assistance. Returns must have an appropriate RMA (Returned Materials Authorization).

- When returning a product to Softopper®, please return all parts in their original packaging. All products must be returned in their original box and include all original packaging materials.
- There is no restocking fee for new/unopened products. If the merchandise has been used, installed, or damaged, the return will be subject to a 20% restocking fee.
- Original shipping, return shipping, taxes, and handling costs are non-refundable.
- Refunds for installation are not permitted once services are rendered.
- Softopper® must receive returns within 30 days of RMA authorization.
- Please allow 10–15 business days for us to process a return after it arrives at our offices.

Exclusions on Returns

- We cannot accept products that are damaged due to negligence, abuse, or misuse.
- We cannot accept products that have not been used in accordance with their documentation or installation instructions.

Returns of Damaged Shipments

If you receive a damaged package, please contact Softopper customer service at info@softopper.com within 30 calendar days of receipt of your package, for assistance.

Regarding damaged shipment claims:

- Please be prepared to describe the damage and provide photographs.
- Once photographs have been captured, please open the box with the inventory what is still contained inside, photographing any damaged parts.
- Softopper will replace any of the parts listed under a warranty.
- Returning a damaged shipment will follow the same procedure and policy as above.